

3-Way Filter Taps





PRE-INSTALLATION INFORMATION

BEFORE INSTALLATION

Attention! The feeding pipes have to be rinsed thoroughly before the installation of the mixer, so that no shavings, welding or hemp residual or other dirt can be found in the pipes. Foreign bodies can enter the mixer through the rinsed pipes or the general water plant and could damage the washers/ring washers.

In order to guarantee a long use of the product, install the angle valve equipped with filter and clean them regularly.

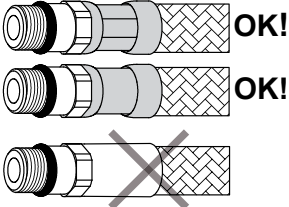
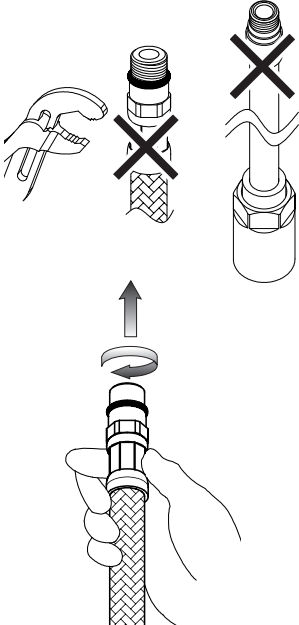
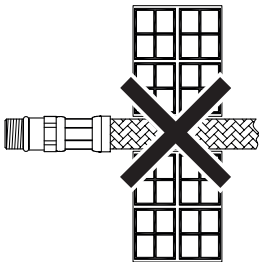
- Respecting this indications, will maintain the warranty rights, ensures the declared properties of the products and warrant the complete reliability.

| | |
|-------------------------------------------------------------------------------------------------------|----------------------------------------------------------------------------------------------------------------|
|  | <p>- Before assembling the hose, please check the appropriate crimping of both sides of the hoses.</p> |
|  | <p>- Don't tighten by tools.</p> <p>- Hand-tighten O-ring seal connectors until feeling a mechanical rest.</p> |
|  | <p>- Don't set the hose in the wall.</p> |
| <p>NO!</p>  | <p>- Tighten the hose without any twist or tension.</p> |

PRE-INSTALLATION INFORMATION

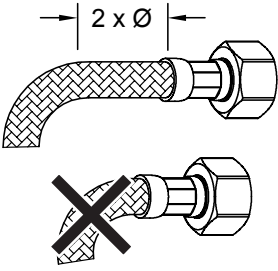
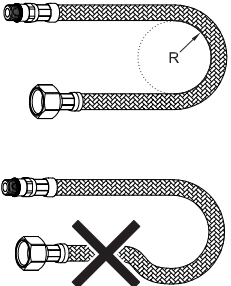
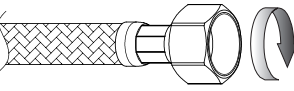
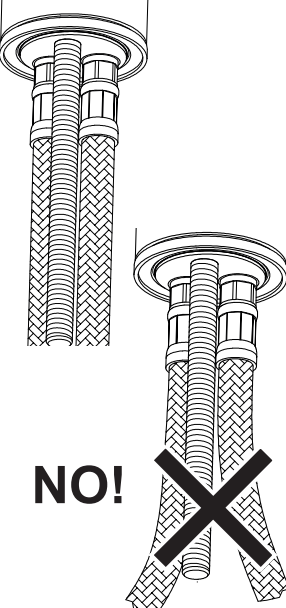
| | | | | | | | | | | | | | |
|-------------------------------------------------------------------------------------|------------------------------------------------------------------------------------------------------------------------------------------------------------------------------------------------------------------------------------------------------------------------------------------------------------------------------------------------------------------------------------------------------------------------------------------------------------------------------------------------------------------------------------------------------------------------------------------|------|---|------|-----|---|------|------|---|------|------|--|------|
|  | <p>- Prolonged contact with any substance, even scarcely aggressive, can cause external braid damage and subsequent lexible burst.</p> | | | | | | | | | | | | |
|  | <p>- Before bending the hose please consider a straight part of 2 times the external diameter.</p> | | | | | | | | | | | | |
|  | <p>- Maintain minimum bend radius (DN= nominal internal diameter):</p> <table style="width: 100%; border-collapse: collapse;"> <tr> <td style="width: 30%;">DN6</td> <td style="width: 10%; text-align: center;">=</td> <td style="width: 60%; text-align: right;">25mm</td> </tr> <tr> <td>DN8</td> <td style="text-align: center;">=</td> <td style="text-align: right;">30mm</td> </tr> <tr> <td>DN10</td> <td style="text-align: center;">=</td> <td style="text-align: right;">35mm</td> </tr> <tr> <td>DN13</td> <td></td> <td style="text-align: right;">45mm</td> </tr> </table> | DN6 | = | 25mm | DN8 | = | 30mm | DN10 | = | 35mm | DN13 | | 45mm |
| DN6 | = | 25mm | | | | | | | | | | | |
| DN8 | = | 30mm | | | | | | | | | | | |
| DN10 | = | 35mm | | | | | | | | | | | |
| DN13 | | 45mm | | | | | | | | | | | |
|  | <p>- Hand-tighten connectors with gasket seal (nuts) as much as possible, then apply 1/4 turn using an appropriate wrench.</p> | | | | | | | | | | | | |
|  | <p>- Do not expose the hose to lateral stress nor overtighten by any tool. (ex. during the installation of the faucet stud or the drain pop-up lever).</p> | | | | | | | | | | | | |

PRE-INSTALLATION INFORMATION

Measures in mm

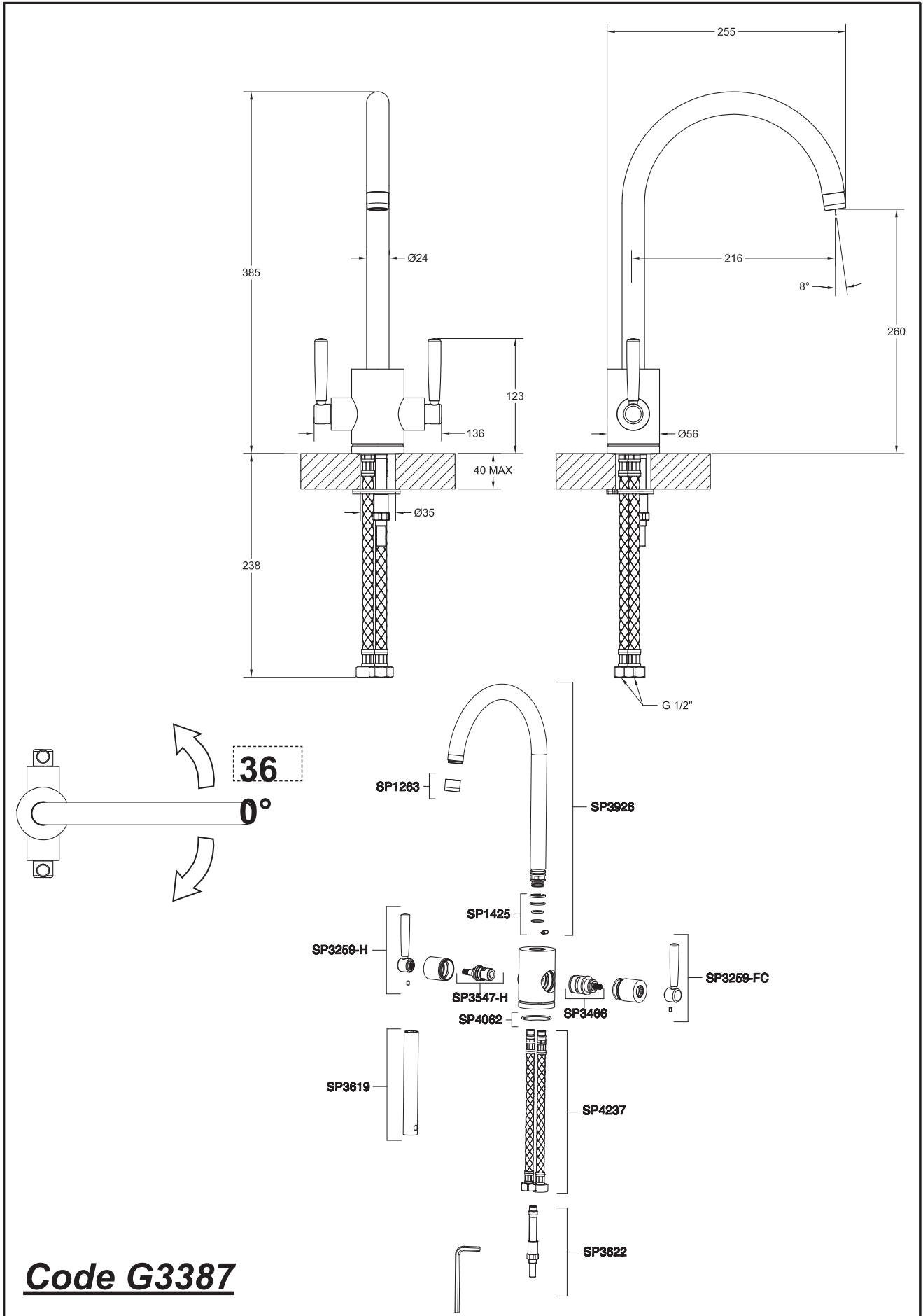

PRE-INSTALLATION INFORMATION

Measures in mm

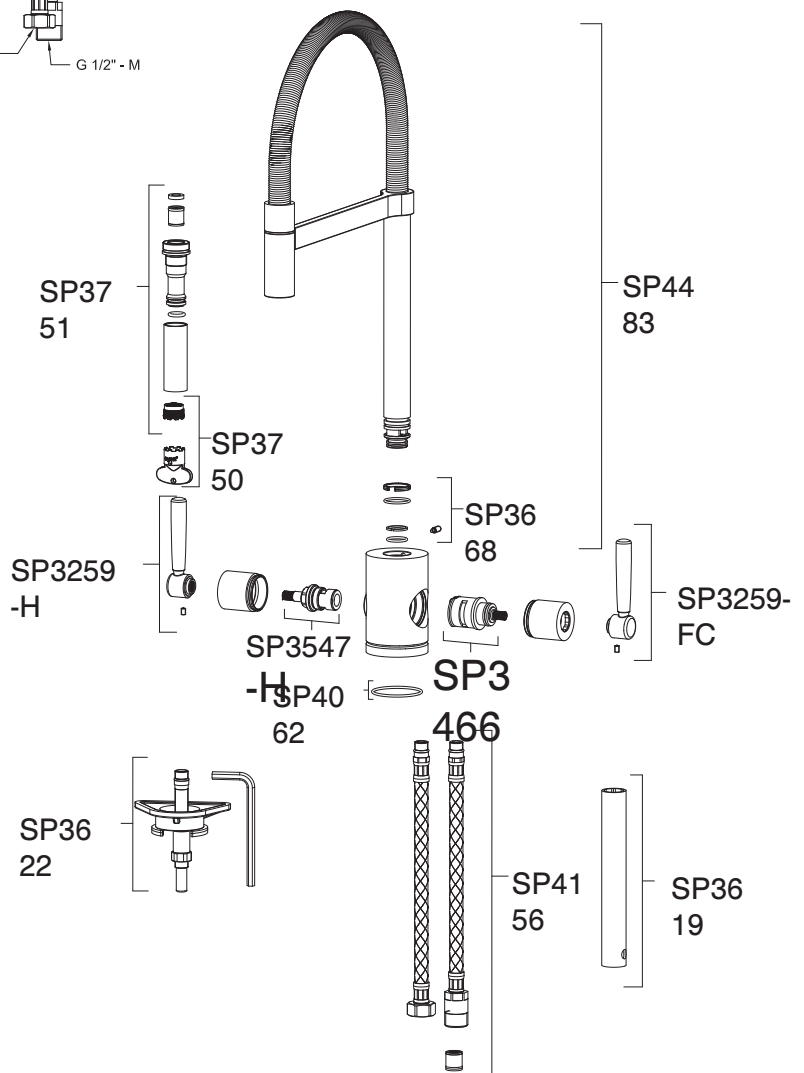
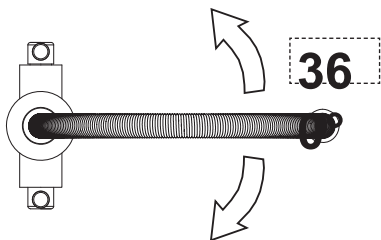
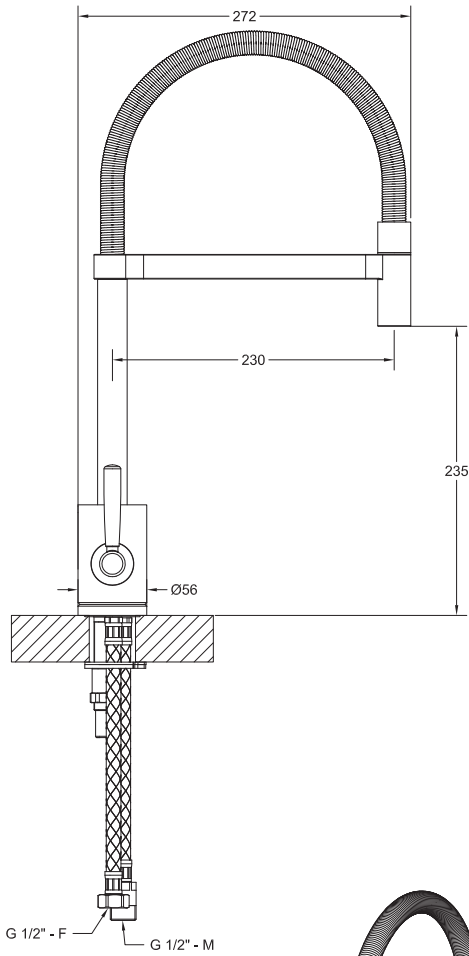
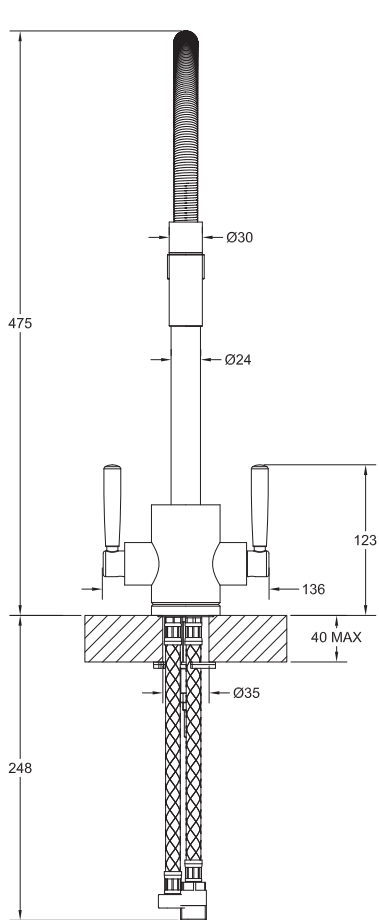

Code G3764

PRE-INSTALLATION INFORMATION

CODES:

- G3387
- G3388
- G3696
- G3697
- G3764
- G3835

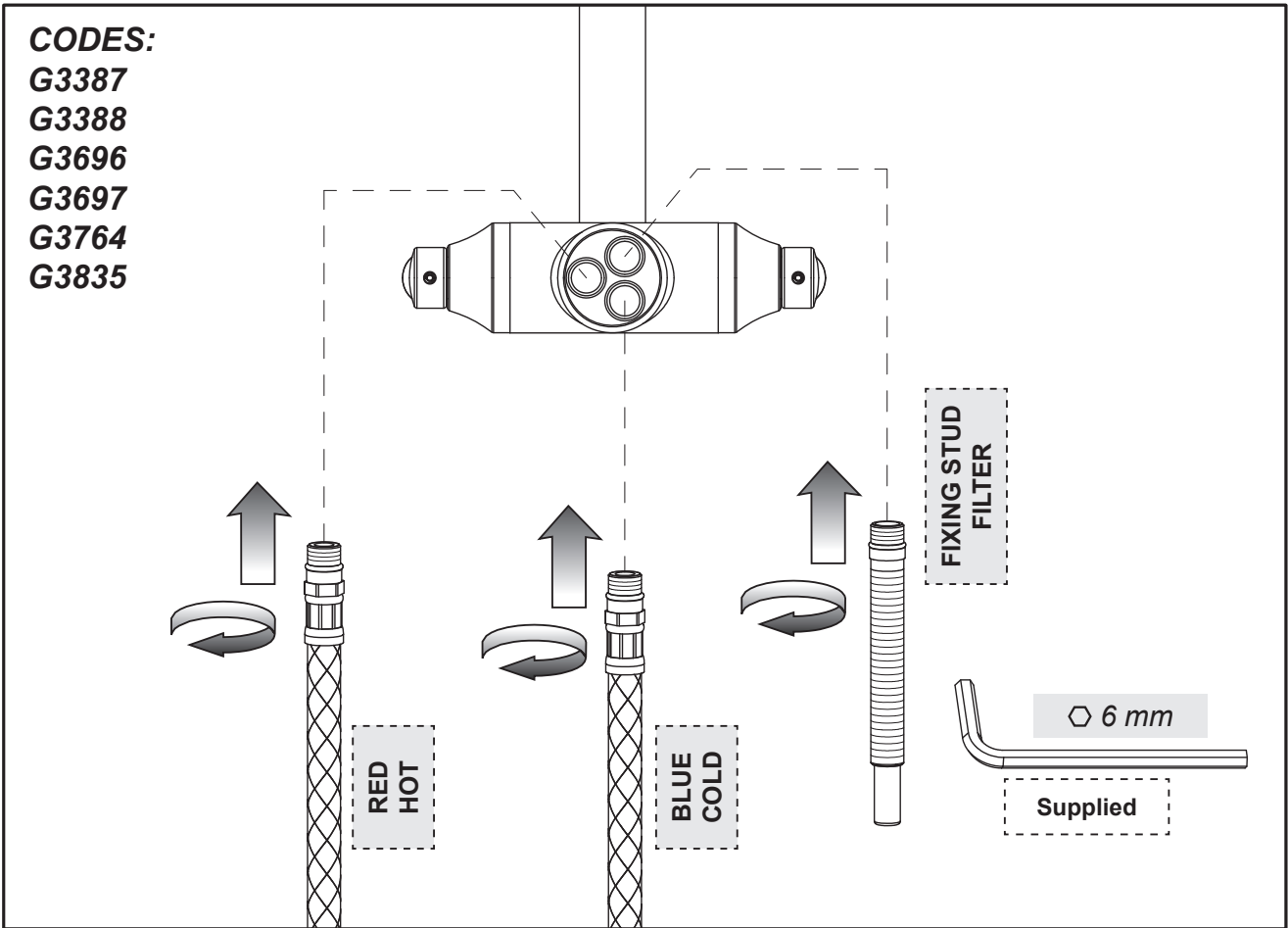

TECHNICAL DATA

| | |
|---------------------------------------------------|---------|
| Supply pressure | 1-5 bar |
| Recommended operating pressure* | 3 bar |
| Maximum operating temperature | 70°C |
| * In case of water bar install pressure reducers. | |

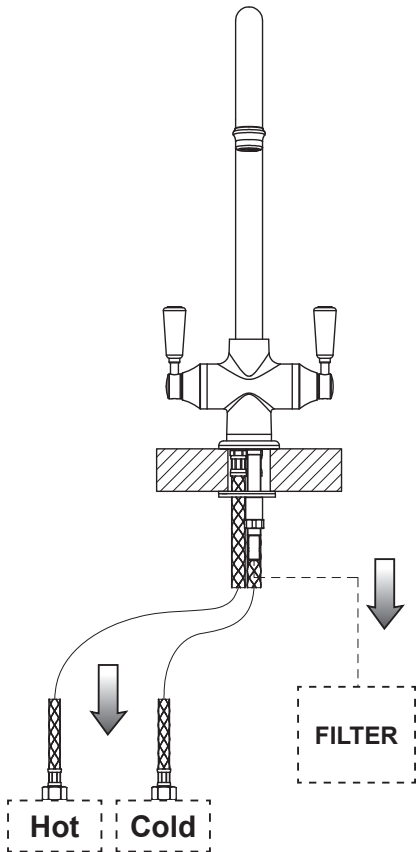
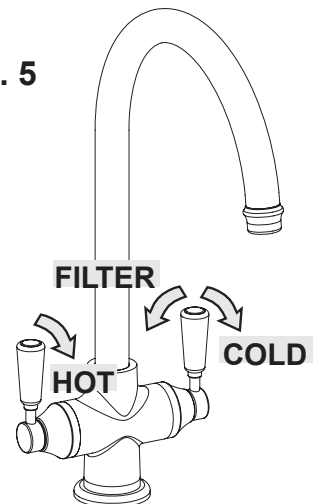

Fig. 5



INSTALLATION

Measures in mm

Fig. 1

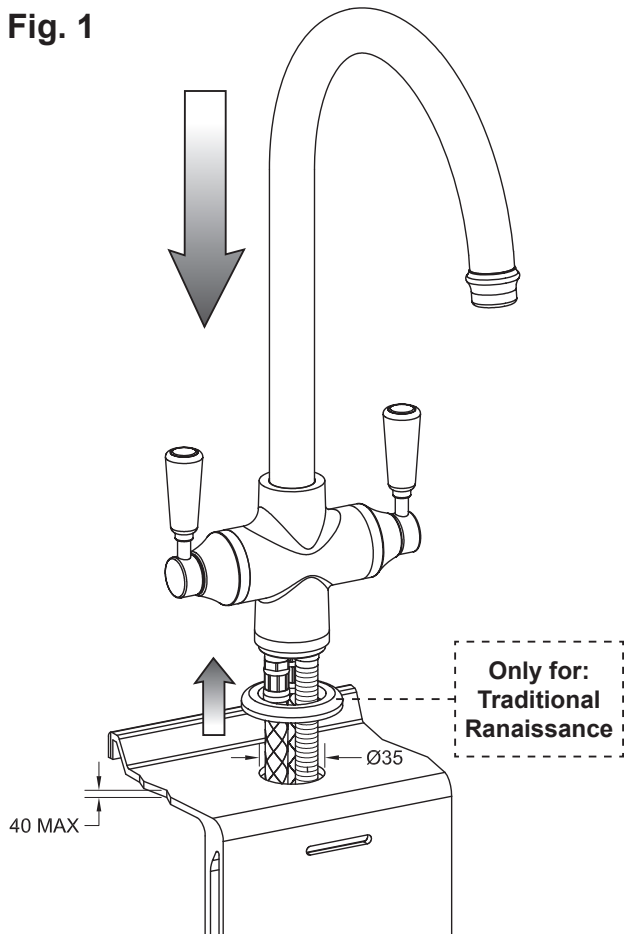

Fig. 2

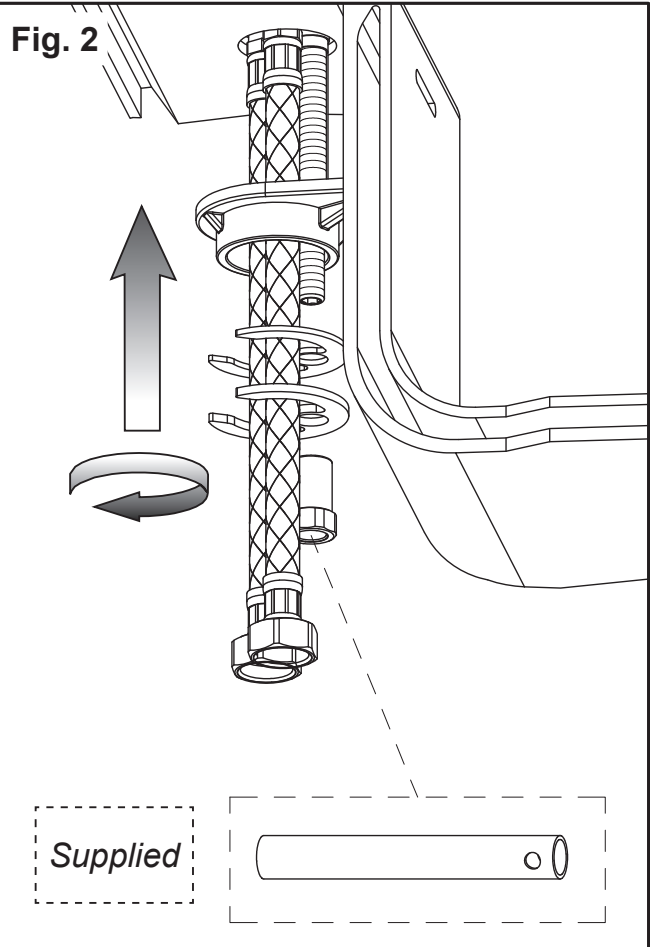

Fig. 3

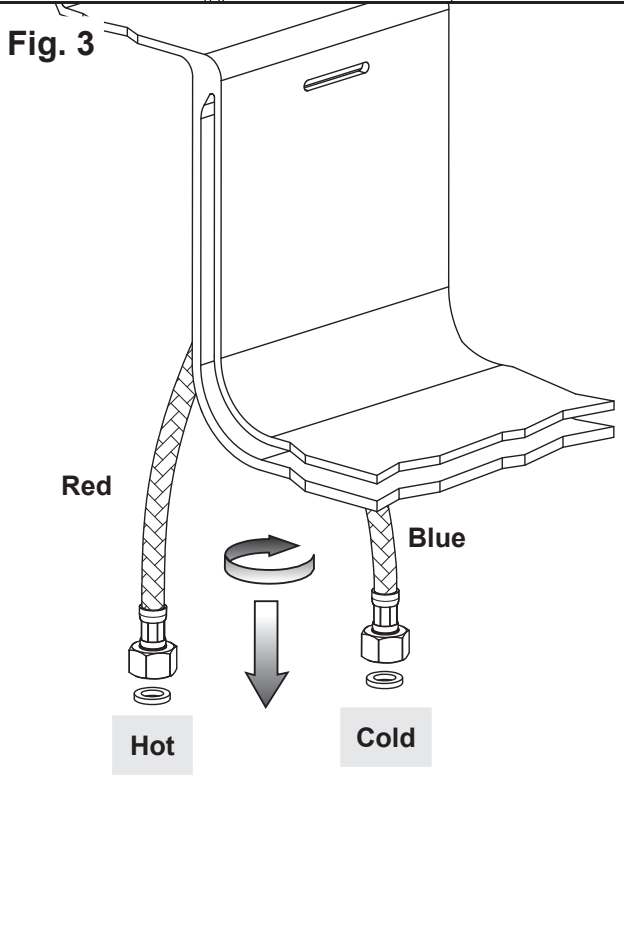
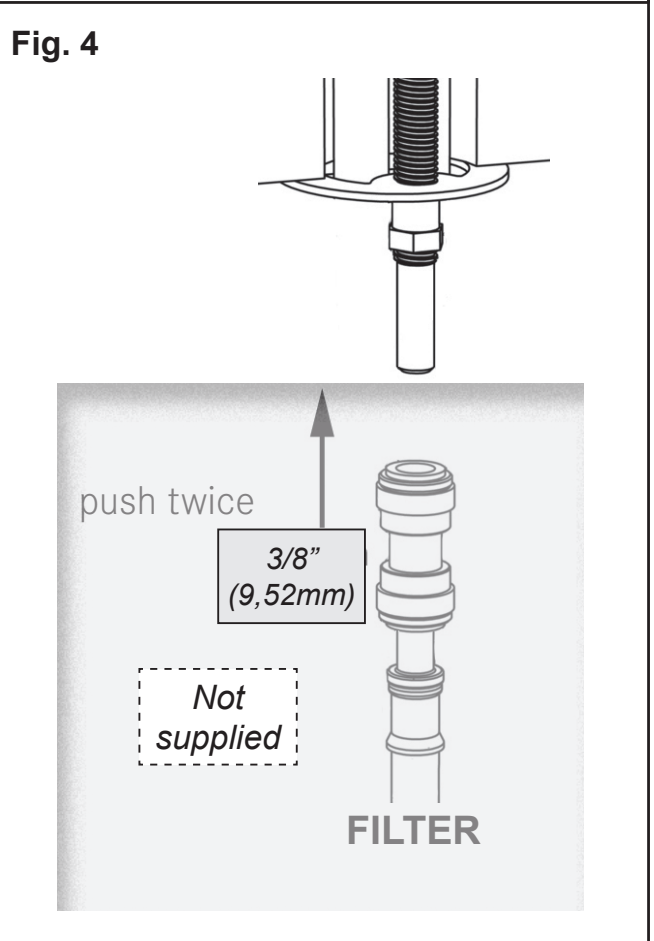
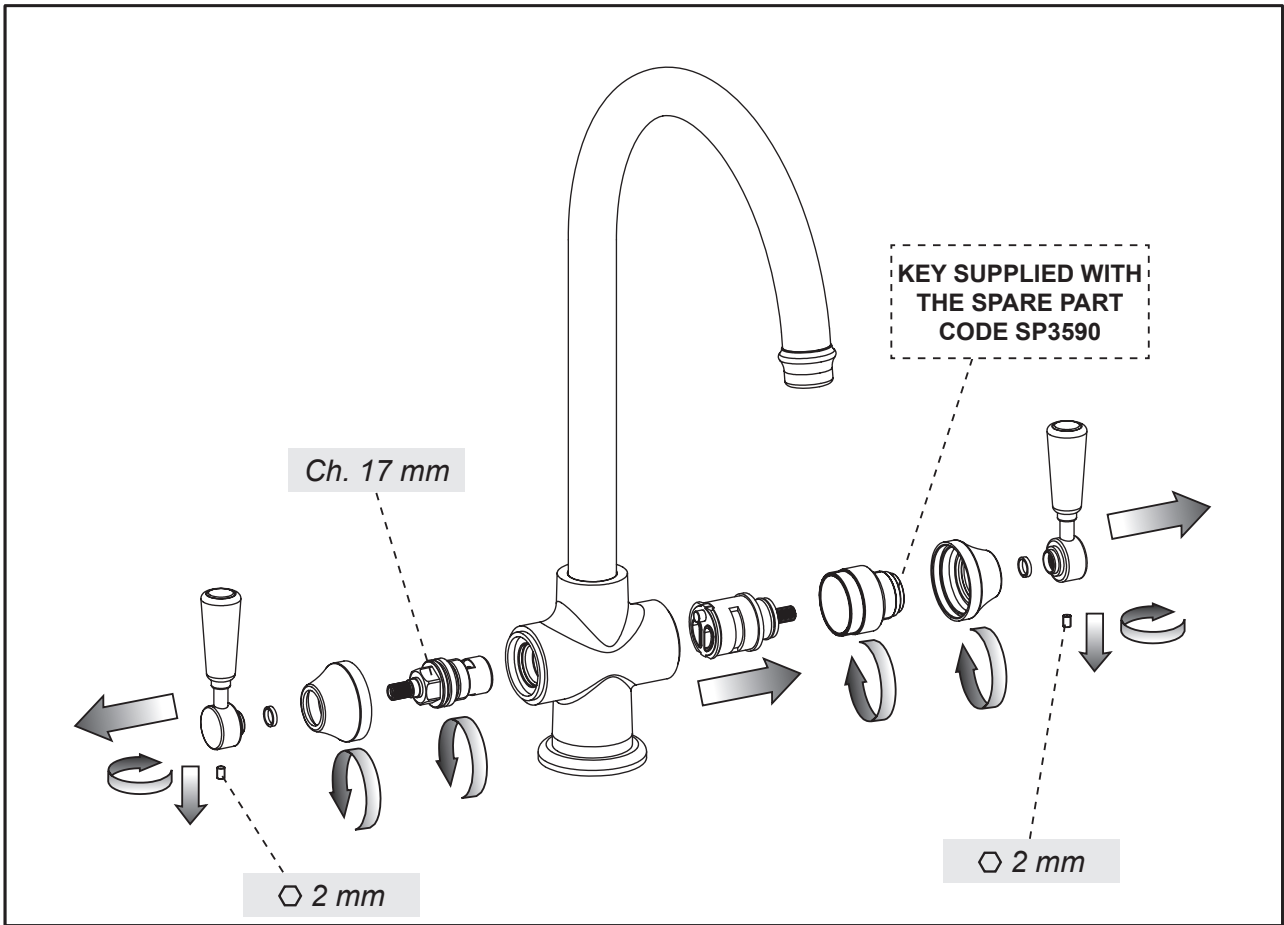

Fig. 4



MAINTENANCE

HEADVALVE / CARTRIDGE REPLACEMENT



AERATOR CLEANING / REPLACING

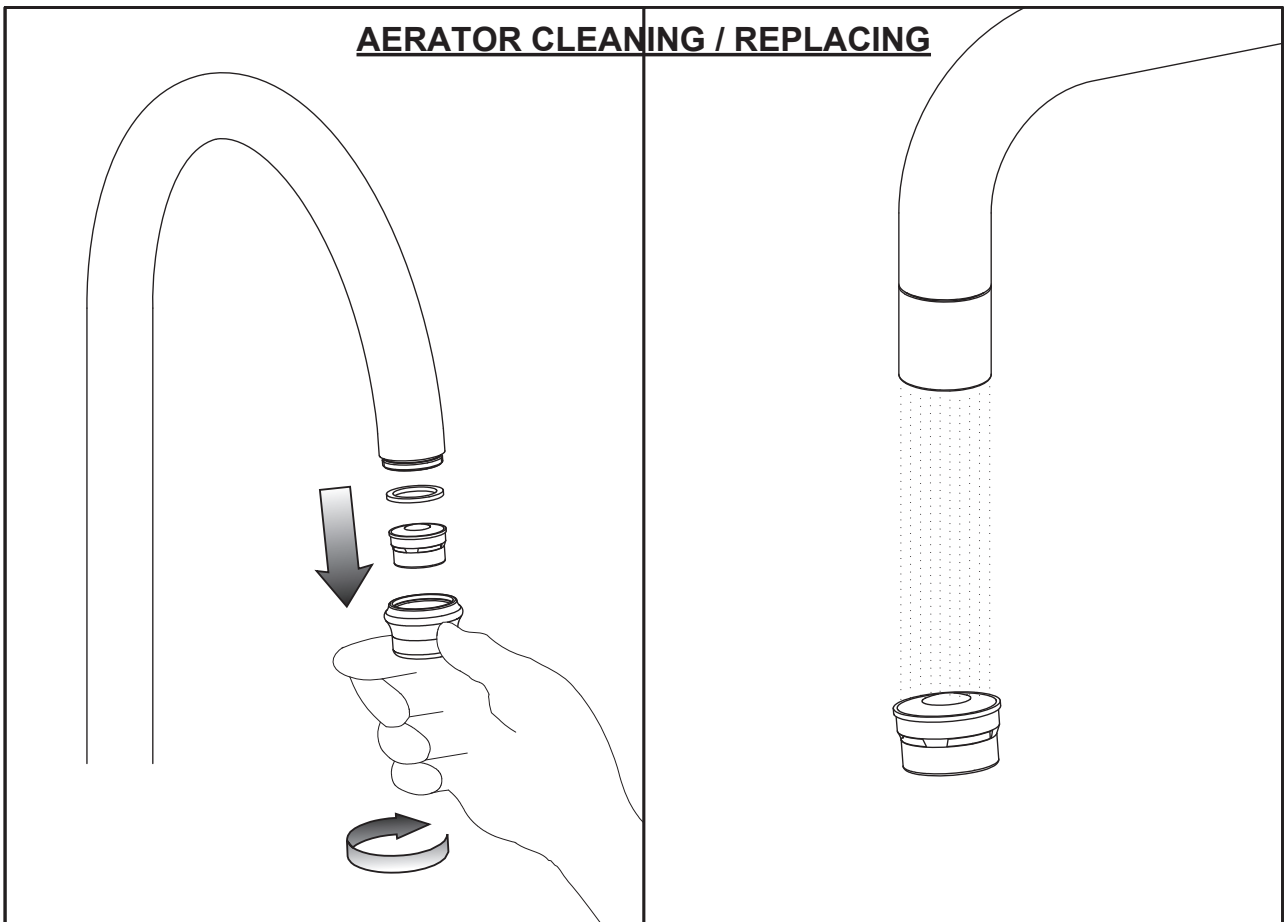

PLEASE ENSURE THAT THE FILTER IS CHANGED EVERY 6 (SIX) MONTHS TO VALIDATE THE WARRANTY

PRE-INSTALLATION INFORMATION

Measures in mm

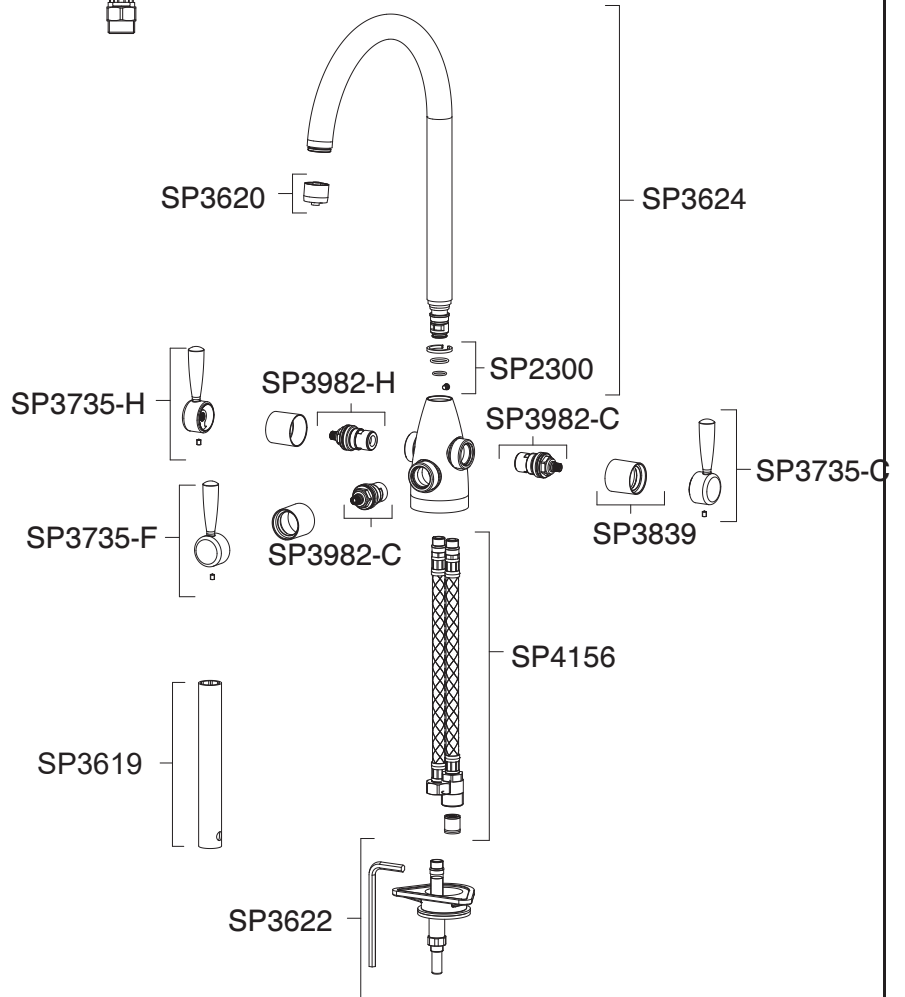
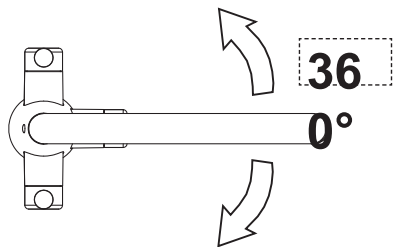
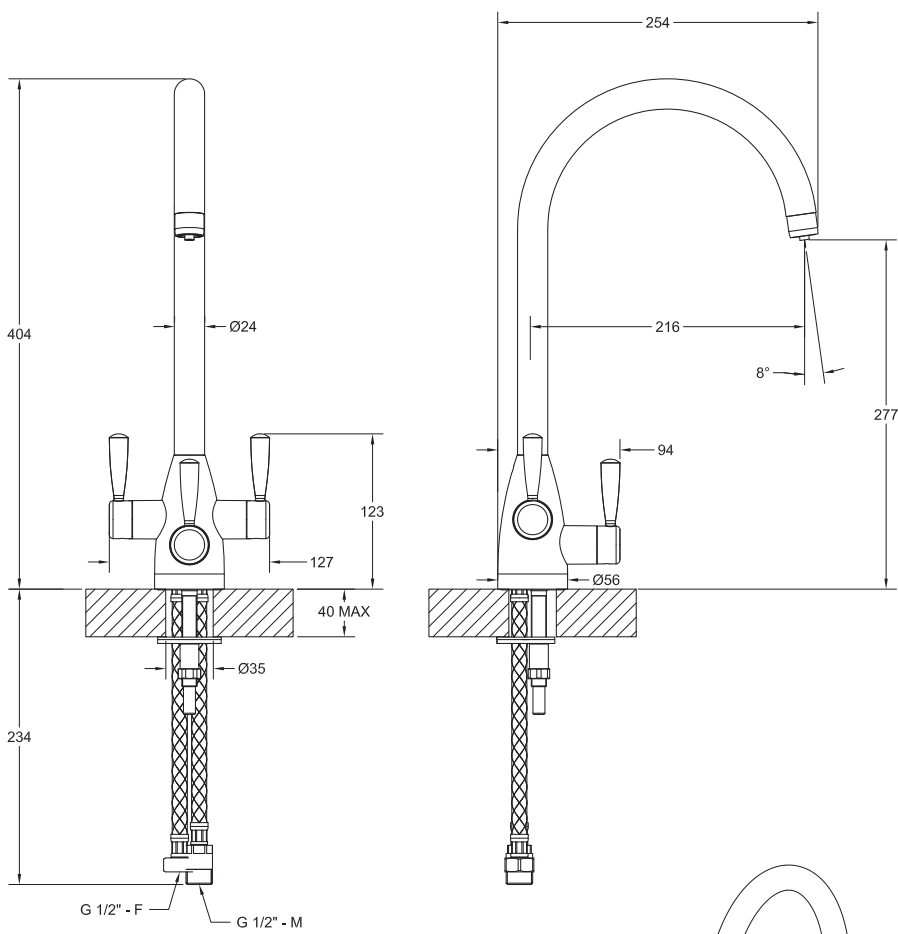

Code G3690

PRE-INSTALLATION INFORMATION

CODES:

G3690

G3691

G3692

G3693

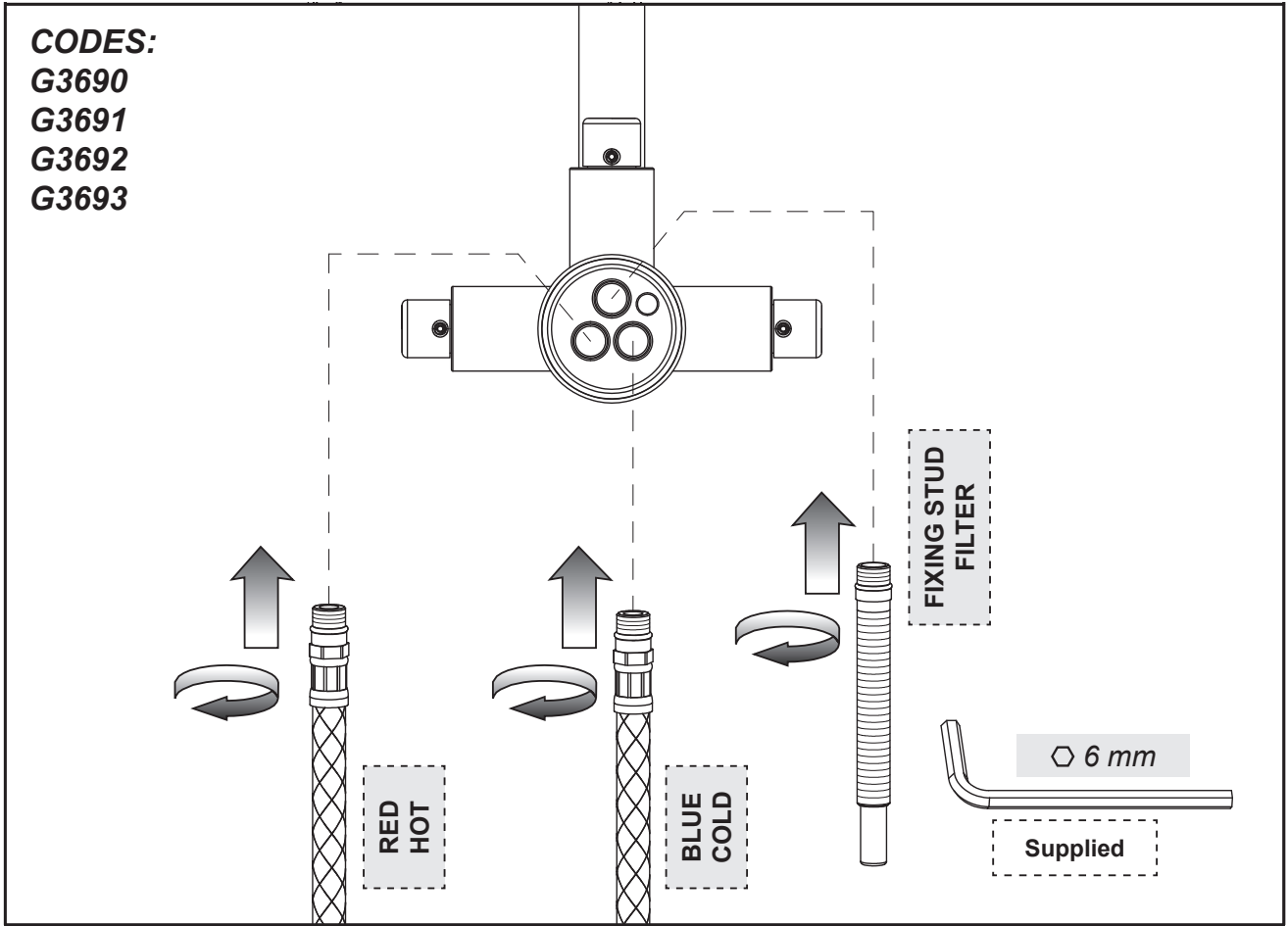

| TECHNICAL DATA | |
|--------------------------------------------------------------------------|---------|
| Supply pressure | 1-5 bar |
| Recommended operating pressure* | 3 bar |
| Maximum operating temperature | 70°C |
| * In case of water pressure higher than 5 bar install pressure reducers. | |

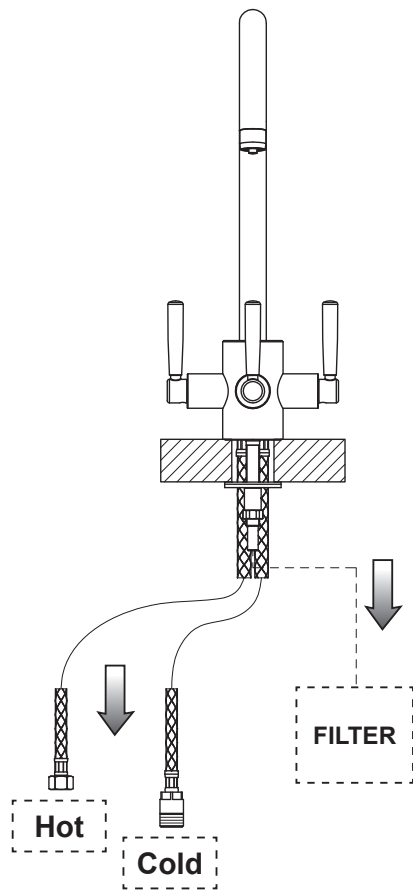
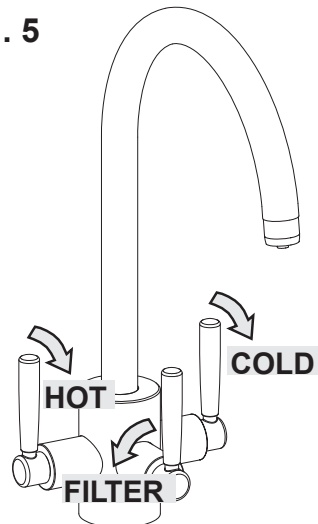

Fig. 5



INSTALLATION

Measures in mm

Fig. 1

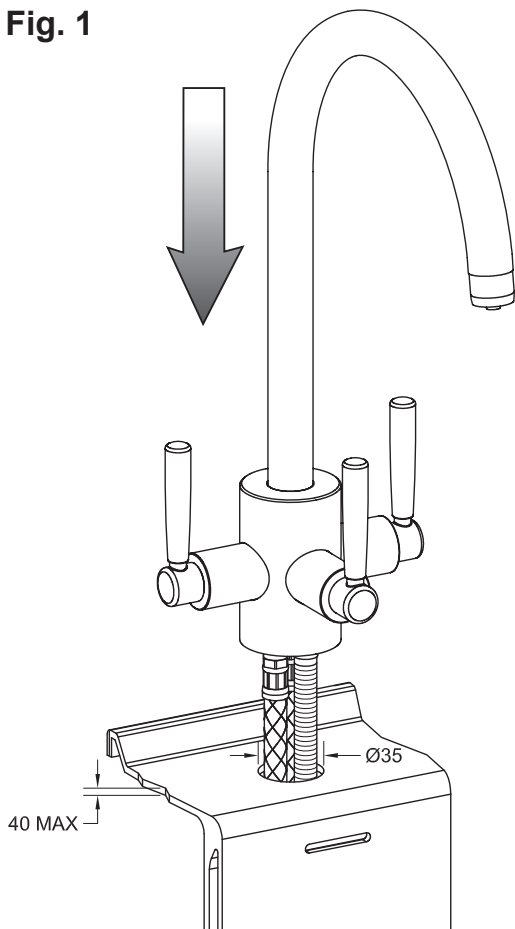

Fig. 2

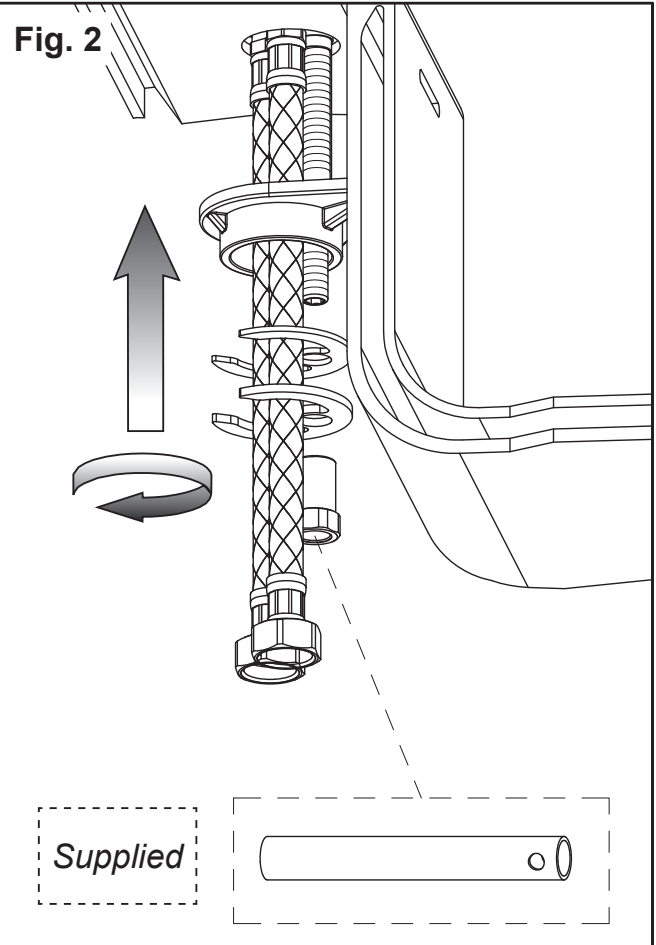

Fig. 3

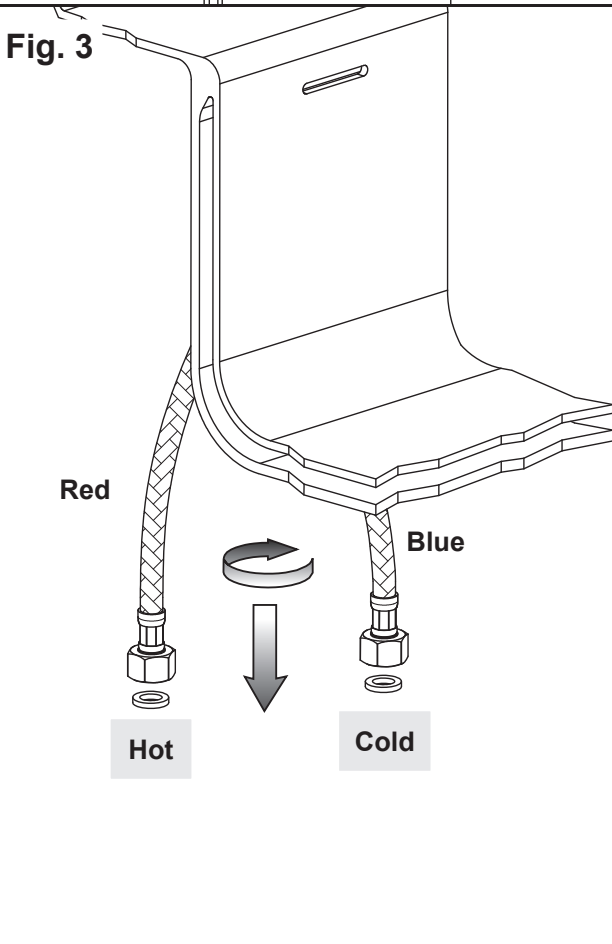
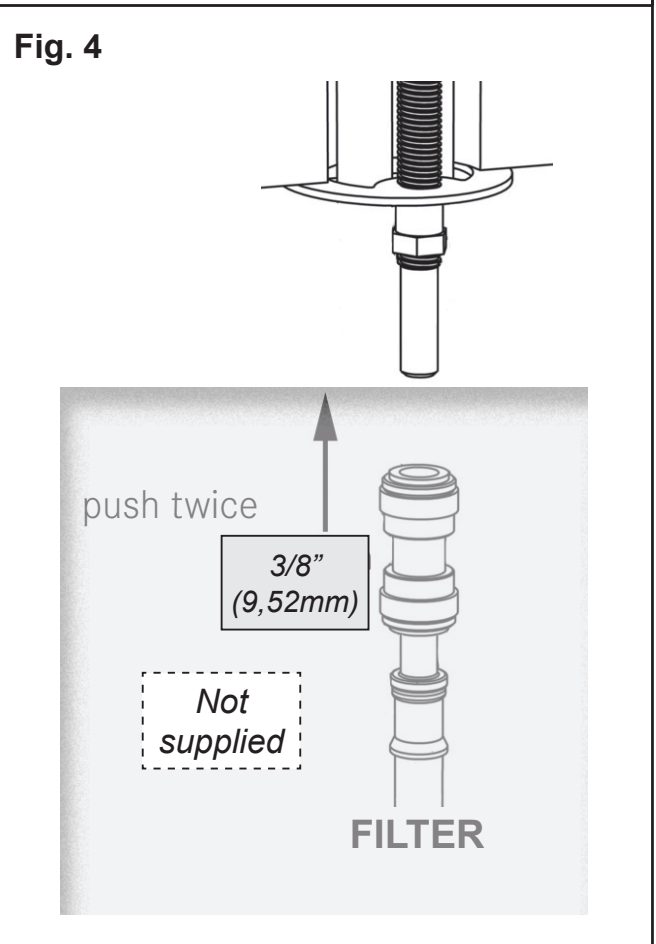
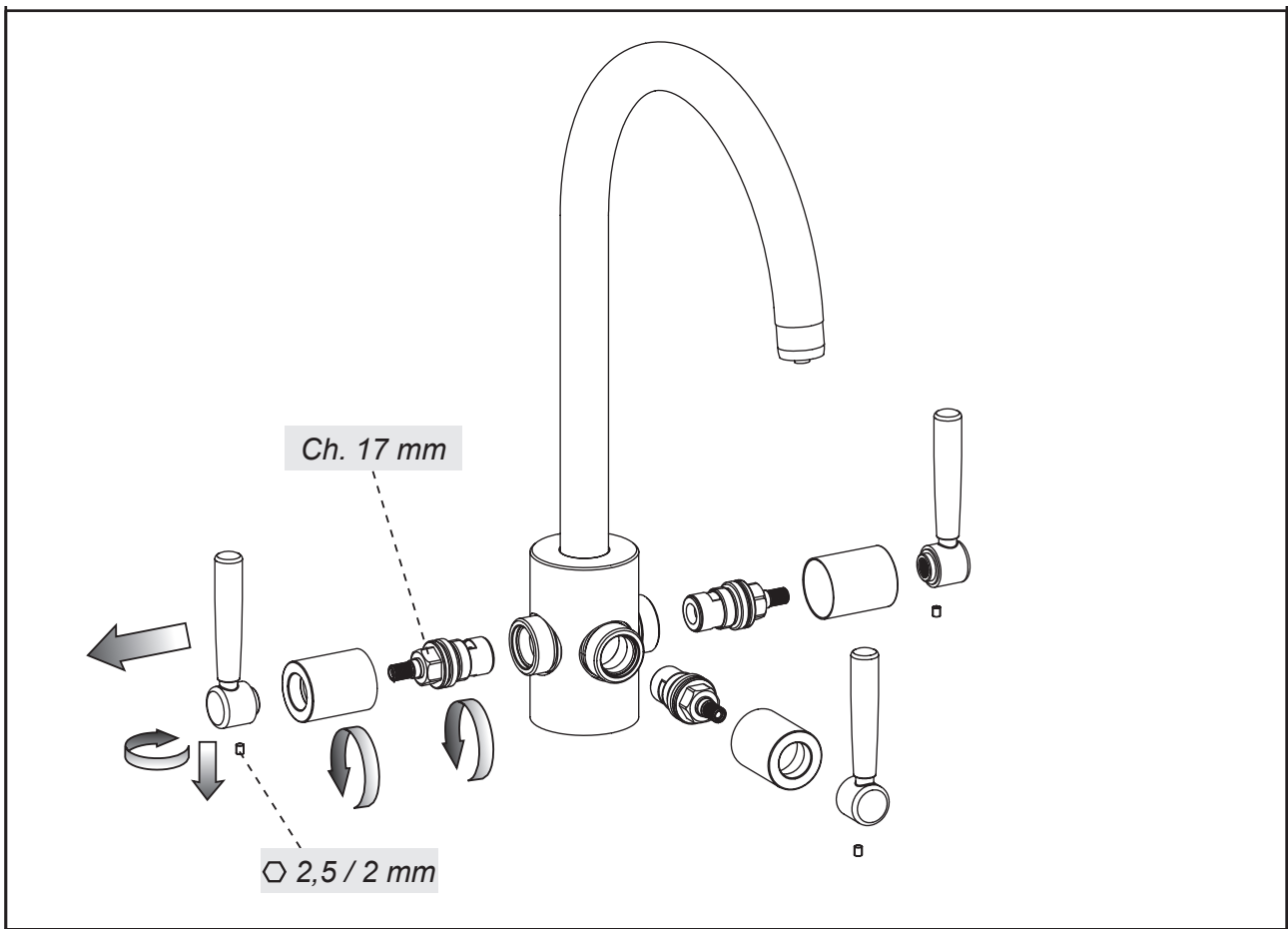

Fig. 4



MAINTENANCE

HEADVALVE / CARTRIDGE REPLACEMENT



AERATOR CLEANING / REPLACING

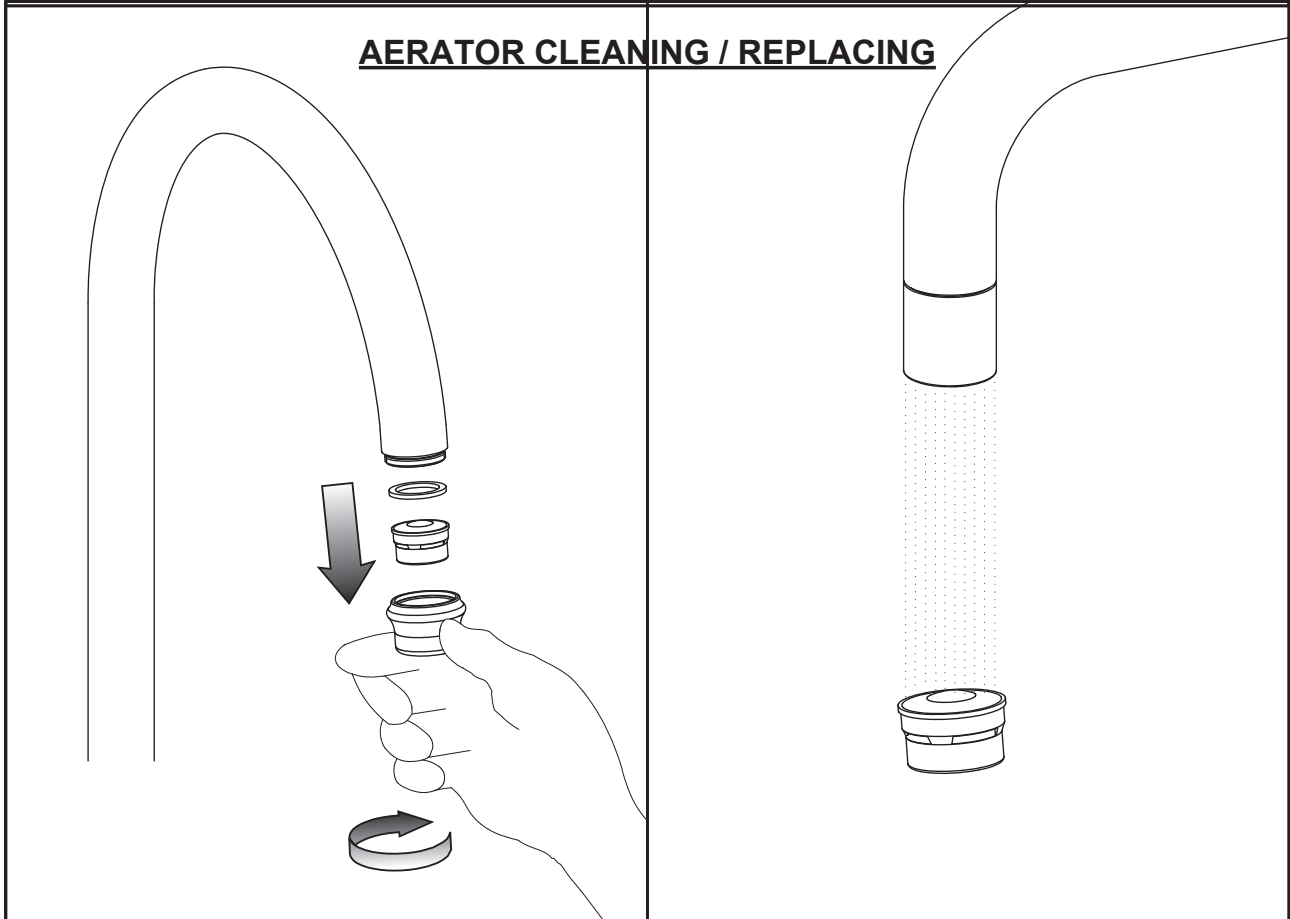

PLEASE ENSURE THAT THE FILTER IS CHANGED EVERY 6 (SIX) MONTHS TO VALIDATE THE WARRANTY

WARRANTY

TERMS OF WARRANTY

The company guarantees its direct manufactured products for established manufacturing and/or production defects for a period of 2 years starting from the date of purchasing to be proved by the suitable fiscal document (receipt - invoice).

The above defects will be removed without any costs during the warranty upon final judgment of the company, by means of repair of the product a/o removing the possible damaged parts a/o by means of the integral replacement of the product.

Parts subject to wear (mixer cartridge, open-close head valve, non return valves, batteries, filters...), upon judgment of the company, are guaranteed for a period of 2 years, always starting from the date of purchase to prove with appropriate tax document (ticket or invoice).

The company is not liable for any malfunction and/or damage whatsoever due to third products associated to its own products.

The warranty is not valid for damages or malfunctioning:

- a) due to improper use and non-conform to the product features a/o to maintenance defect;
- b) caused by transport;
- c) due to impacts, tampering, wrong repairs a/o repairs carried out by unauthorized staff;
- d) caused by freezing a/o foreign bodies present in the piping;
- e) observed on mechanical components and on electrical or electronic parts due to their improper use or to installation carried out by unskilled staff or however to installation not carried out according to the wrapping instructions;
- f) caused by third factors (atmospheric agents, fires, natural disaster, war and violent events following rebellions or revolts);
- g) due to the non-observance of the hereafter indicated technical and maintenance prescriptions.

MAINTENANCE: INDICATIONS FOR THE CLEANING OF THE COMPANY'S PRODUCTS

The company's products are manufactured articles of different materials according to any requirement of the market, design and functionality. The surfaces of the company's manufacturing are obtained using the best materials, approved production processes and are constantly checked by updated quality certification methods. To fully appreciate your product and to preserve its aesthetic quality, consider the following:

- A) Water contains limestone in different qualities, which remains kept on the surfaces of the product, leaving deposits after the water has been evaporated. It is possible to prevent the forming of limestone deposits and to keep your product clean by drying it always with a soft cloth immediately after use.
- B) DETERGENTS, SOLVENTS, CHEMICAL AGENTS, ABRASIVE SPONGES, WIRE WOOL, ALCOHOL, ETC. SHOULD NOT BE USED as these could irreparably damage products' surfaces compromising their aesthetics, brightness and satinizing. CLEAN ONLY WITH WATER AND NEUTRAL SOAP WIPING WITH A SOFT CLOTH.
- C) Clean regularly the aerator filter after having it disassembled and after having removed the limestone which obstructs the outlets.
- D) When using spray soap, splash first on a clean cloth or on a sponge, NEVER directly on the product.

The company has the right to invalidate the warranty when the above mentioned conditions will not be obeyed, checked by a technician of the company.

The company can issue only any modifications at this warranty through a proper written declaration. Furthermore, the warranty will not be valid in case of missing documentation which proves the date of purchase. Possible product damages a/o defects will be replaced under warranty only if the related item of complaint is send back the company in the original packaging including the proof of purchase. This warranty is valid only and exclusively for all the countries in which the product guaranteed by this warranty is directly supplied by the company or by the local distribution by one of its authorized dealers and is absolutely not valid in any other case. The costs for the assembling and the disassembling of the product, the travelling and the technical interventions by the skilled staff, as well as the burden undergone by the customer due to the indisposition a/o the suspension of the product use are in any case excluded from the warranty. Possible imperfections at the finishing and at the raw materials, are not defects, but features of the product due to the handmade production.



www.geysertaps.com